

tempmate.®-S1 v2

➔ Single-Use USB Data Logger for Cold Chain Temperature Monitoring



➔ 2 Years Shelf-Life¹

➔ Automatic PDF & CSV Report

➔ Up to 180 Days² Recording

➔ Reprogrammable

➔ Comes with a 6 point Certificate of Validation

➔ Active and Status LEDs

➔ Up to 5 Alarm Limits

➔ Backup-Log Feature³

1 Depending on Storage Conditions | 2 Depending on Configuration | 3 Background Logging, even if stopped too early



PHARMACEUTICAL
PRODUCTS



FOOD & PRODUCE



TECHNICAL
PRODUCTS

Outstanding Single-Use Temperature Logger, for Reliable Cold Chain Monitoring.

The new **tempmate.®-S1 v2** loggers have an integrated USB port and PDF & CSV generating software on-board, so no further software or hardware is required to connect the logger and read the recorded temperature data. **tempmate.®-S1 v2** data loggers have an accuracy of +/- 0.5°C and come with a 6 point NIST traceable Certificate of Validation. This validation, straight from the manufacturer, saves you time, money, and offers quality assurance for your compliance needs.



tempmate.com



USB
Connection



IP 67
Protected



Temperature Range
-30°C to +70°C



GDP
compliant



EN 12830
Compliant



Automatic PDF
& CSV Report



Germany
Quality

tempmate.®-S1 v2

If temperature matters.

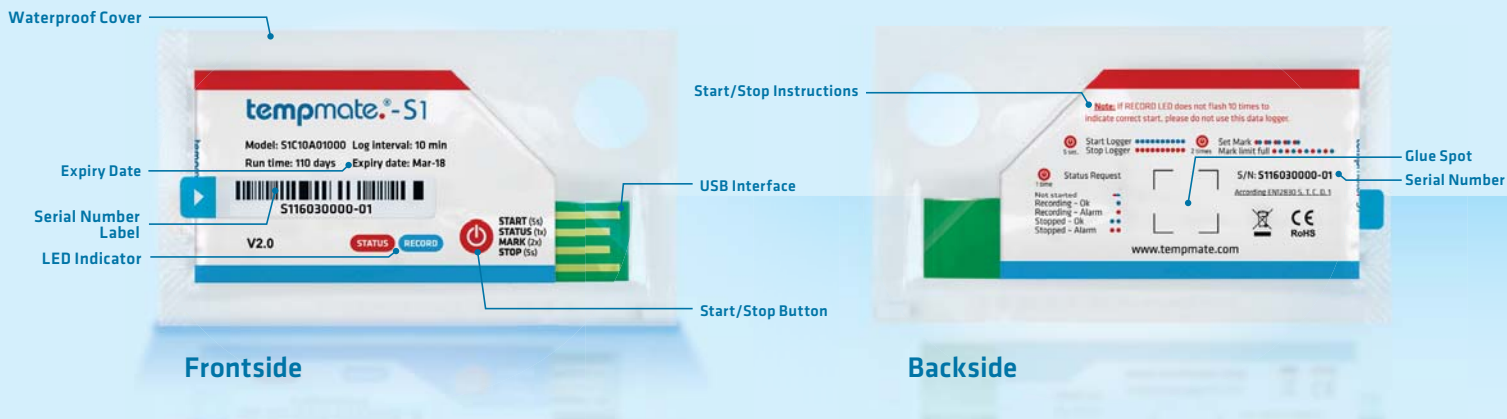

Easy Handling

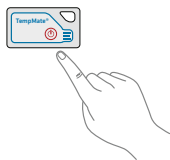

01 Preconfigured and ready to use

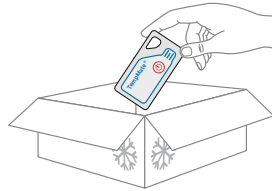

02 Add started tempmate.®-S1 to your Shipment

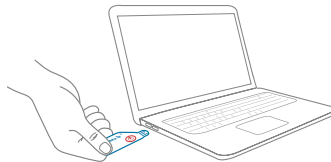

03 Connect stopped Logger directly to USB Port



04 Automated PDF & CSV Report with all Details

Curious about your Cold Chain?

tempmate.®-S1 continuously monitors all relevant data.

tempmate.®-S1 loggers are specially designed for temperature monitoring in any cold chain logistics. As a pre-programmed device tempmate.®-S1 can be instantly used to monitor your temperature sensitive consignment. The automatically created PDF and CSV report, containing detailed information such as data curve, every single measurement as a table and statistical information. The optional tempbase.® software for data management and reprogramming can be downloaded for free.

Your Benefits at a Glance

- + Cost-Effective and Reliable
- + Smart Design, Intuitive Operation
- + Waterproof and Food Grade Packing
- + No Additional Hardware or Software Required
- + Detailed PDF and CSV Report Including Graph and Table
- + Intelligent LEDs for Status Monitoring
- + Extended Shelf-Life of 2 Years
- + Reprogrammable

Technical Specifications

Recording Options	Single-Use
Temperature Range	-30 °C to 70 °C
Temperature Accuracy	±0.5 °C (-20 °C/+40 °C); ±1.0 °C (other range)
Temperature Resolution	0.1 °C
Data Storage Capacity	16.000 readings
Shelf Life / Battery	2 years ¹ / CR2450 button cell
Recording Interval	10 minutes (standard, others on request)
Recording Duration	up to 110 days ² (standard, others on request)
Startup Mode	Button or software
Stop Mode	Button, software or stop when full
Protection Class	IP67 / NEMA 6
Dimensions	83 mm × 47 mm × 7 mm (L × W × H)

Weight	14.6 g
Certifications	EN 12830, CE, RoHS
Validation Certificate	Hardcopy and PDF file in memory
Software	PDF or CSV Reader / tempbase.® optional
Report Generation	Automatic PDF & CSV report
Password Protection	Optional on request
Connection Interface	USB 2.0, A-Type
Alarm Configuration	Optional, up to 5 points
Reprogrammable	Yes, with free tempbase.® software
Accessories incl.	Shipping Documents, Certificate, Reprogram Label and Seal-Bag

1 Depending on optimal storage conditions (+15 °C to +23 °C / 45% to 75% rH)
2 Depending on application temperature (very low / high temperatures may shorten it)



imec Messtechnik GmbH
Deutschland

Lilienthalstraße 23
74078 Heilbronn

T +49 7066.9150 230
F +49 7066.9150 233

info@imec.de
www.imec.de

